

Beacon[®]

Inventory Management System



Beacon® Inventory Management for any size organization – from large integrated networks, retail chains or a single-site location, Beacon gives you dashboards and reports that empower your business to reduce inventory holding costs at any level and in any size organization.



Why Beacon?

Inventory Management

- Reduction in inventory and increase in turns
- Fewer expired medications
- Ease of NDC changes
- Improved accuracy and faster fill times

Fixtures

- Control medication handling
- Space savings
- Less pill dust
- Easy to clean

Workflow Engineering

- Adaptable design with less expenditure as your pharmacy needs change
- Create space for MTM, consulting, vaccination areas
- Workflow improvements from stock to delivery
- Faster fill rates



"Beacon has reduced our documented dispensing error rate by 62.2%, while also trending our inventory cost down by 21.4% in the face of 3% to 8% rising drug cost, and contributing to our fiscal year goals."

Jeff Binkley, Director of Pharmacy, Maury Regional Medical Center

Beacon® — ROI

Beacon offers a one-of-a-kind inventory management system that integrates with your pharmacy information system. Using barcode-driven technology, it tracks all of your formulary from the bottle, down to the pill level.

By using barcodes with Beacon, our customers have proven results of:

- Reduced inventory
- Less expired medications
- Ability to return soon-to-expire, unopened meds
- Increased turns
- Increased accuracy

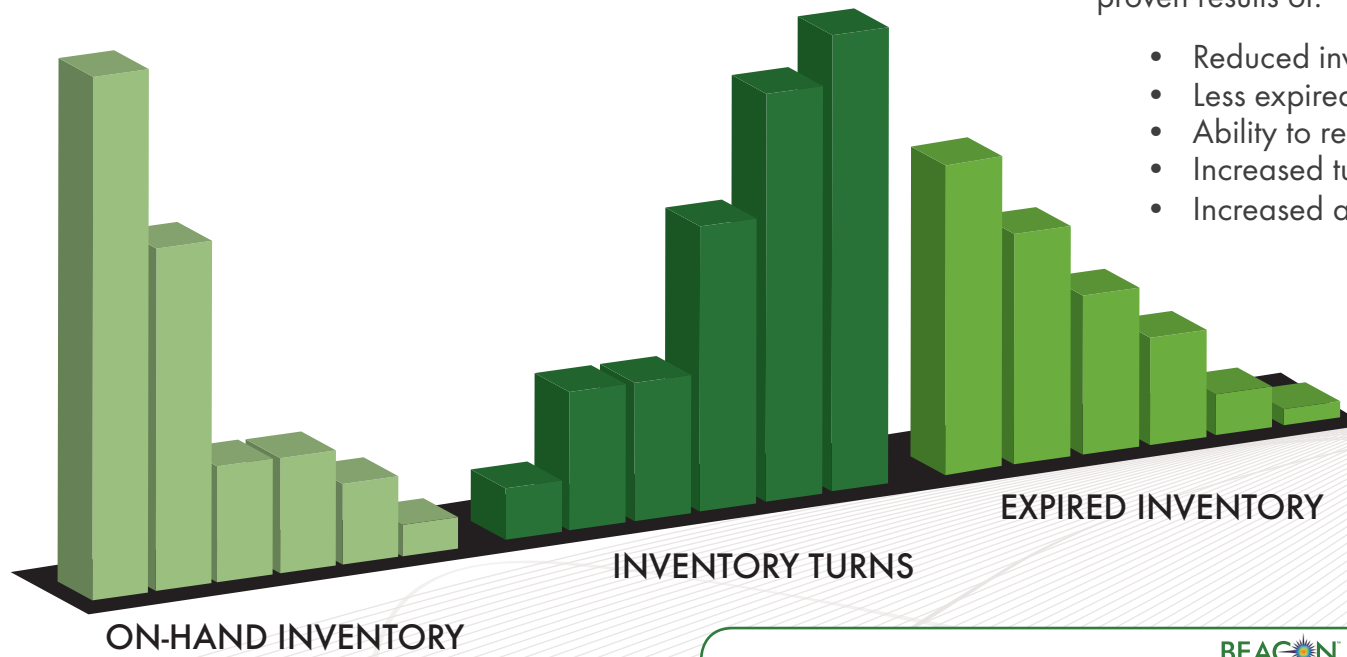

Beacon Chain of Custody

- Every SKU scanned and tracked by NDC, expiration and lot number if required
- Every touch, every script tracked and reported
- Patient pickup and delivery tracking tools

BEACON Dispensed History

Summary View
Filler: None

Customer Rx	Patient	NDC	Customer NDC	Medications	Qty	Total Cost	Date
RX15183709A	ADAMS DONNA	55513007830	55513007830	SENSIPAR CINCALCET HCL 30 MG	50	\$372.40	1/29/20XX 5:23:56 PM
RX12933580B	BLYE TOM	55111011901	55111011901	FAMOTIDINE FAMOTIDINE 20 MG	50	\$1.70	01/29/20XX 5:27:07 PM
RX14843690B	ECKERT SALLY	00008060701	00008060701	PANTOPRAZOLE PANTOPRAZOLE 40 MG	50	\$298.75	01/29/20XX 5:31:09 PM
RX1484369A	ECKERT SALLY	68180051901	68180051901	LISINOPRIL-HCTZ LISINOPRIL/HYDROCHLOROTHAZIDE 20-12.5 MG	50	\$1.25	01/29/20XX 5:28:48 PM



Beacon®

Beacon is a light-guided, barcode-driven perpetual inventory system.

- Light guides to the bay and bottle location
- Barcode validation of medication
- Alert for wrong medication
- Light guides for restock



Stocking



- Scan product
- Scan expiration sheet
- Scan location

Benefits:

- No sorting totes from wholesaler
- No "walking the shelves"
- Random stocking eliminates look alike, sound alike
- Bottle/Item level inventory control

Picking



- Scan Rx
- Scan medication
- Return to stock

Benefits:

- Guides to open item first, then shortest to expire
- Picks the right item every time
- Reduces open bottles and
- Total carrying inventory

Beacon[®]

HOW DOES IT WORK?

"Beacon has allowed us to eliminate expired medications, manage the move of Hydrocodone to a Schedule 2, and reduce our fill labor. The return was more than we expected."

Brian Kramer, CEO, Forum Extended Care Services



Stocking Made Simple

Gone are the days of walking shelves, license plating and sorting wholesaler's totes. Beacon provides handheld stocking devices to free them from a desktop environment – to reduce walking, eliminate alphabetizing, and prevent stocking errors.

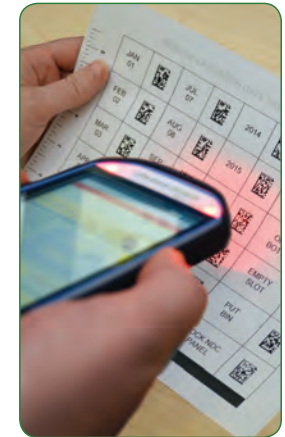
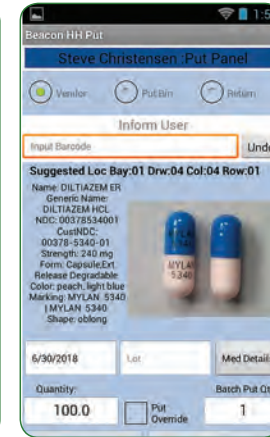

Beacon Companion

Beacon Companion is an application that enables the order entry technician to view Beacon's inventory of the prescribed medication as well as the equivalent NDCs, so the technician can select the best NDC in Beacon to fill the script.

- Reduces adjudication reversals and re-submissions
 - Saves adjudication cost
 - Improves workflow
- Improves inventory management of generic equivalents and substitutions
- Reduces medication outdates

Search by brand or generic name ***Displaying only in stock items**

LORTAB, HYDROCODONE BIT/ACETAMINOPHEN, 5-500 MG. Tablet Extended Release

Clear

◆ NDC	◆ Brand Name	◆ Generic Name	◆ Strength	◆ Dosage Form	◆ Manufacturer	◆ Qty	◆ Stock Date	◆ Expiration Date
1 00406831501	MORPHINE SULFATE ER	MORPHINE SULFATE ER	15 MG	Tablet Extended Release	MALLINKRT PHARM	80	10/28/20XX	07/31/20XX
2 00406831501	MORPHINE SULFATE ER	MORPHINE SULFATE ER	15 MG	Tablet Extended Release	MALLINKRT PHARM	100	11/17/20XX	07/30/20XX
3 42858080101	MORPHINE SULFATE ER	MORPHINE SULFATE	15 MG	Tablet Extended Release	MALLINKRT PHARM	30	10/23/20XX	04/20/20XX

Will-Call Aging

Sort: HangDate, Location, BagLabel
Filter: HangDate < 12/24/20XX

Location	Bag Label	Hang Date	Location
51-02-35-01	20111100506	12/16/20XX	
RX Number RX2774601A	Patient Name Adams, Kim		Phone Number (297)663-4439
51-02-25-01	20111101732	12/16/20XX	
RX Number RX5077323A	Patient Name Adams, Joshua		Phone Number (263)015-7034
51-03-38-01	20111101680	11/25/20XX	
RX Number RX241527589	Patient Name Test, John		Phone Number (263)015-7034

DeliverRx™ Will-Call

- Prescription status
- Multiple location reminders
- Fast, accurate delivery
- Return to Stock feature
- Reports Include:
 - » Call Aging
 - » Bag Contents
 - » Bag Contents by Customer

Beacon® Storage Solutions



High Density Cabinets

TCGRx offers the finest in high-density fixtures. Our fixtures can save space, create a state of the art appearance in your pharmacy, and reduce walk time. When Beacon is included, stocking becomes faster, filling is simplified, and inventory management made easier.

- Holds an average of 1,100 items in 10 square feet, compared to 39 square feet of traditional shelving
- Locking drawers available
- Customizable for small or large bottles, liquids, vials or bulk stock

Cabinet Color Options

Beige (Std.) White (Std.)

Red

Yellow

Green

Custom

Blue



Drawer front options

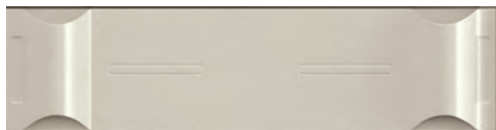

Room for small or bulk bottles



PharmLoc™

PharmLoc secures At-Risk Meds (ARM) by incorporating Beacon's technology with software electronic controlled locks. PharmLoc utilizes Beacon® High-Density (HD) drawers – configurable from a few drawers to the entire cabinet.

PharmLoc features as high-density cabinets plus:

- Computer login or biometric access for ARMs (Control or high-value medications)
- Blind count or verify count options for ARMs
- Automatic electronic locking drawers with manual override for power failures

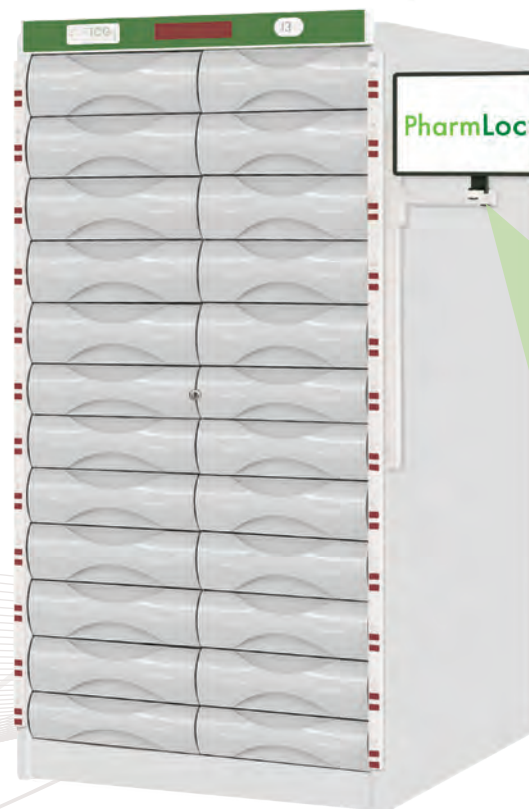

Biometric finger scan



Workstations

Workstations are designed to facilitate the prescription fulfillment process. Our unique workstations integrate storage with counter tops. We can reduce your storage footprint, while increasing counter space.

- Speed shelves for fast-moving medications
- Capacity of 350 items per bay
- Configurable in 1, 2 or 3 bays with drawers, flat shelves or speed shelves



Pull-down
Speed Shelves



Barcode-driven
locations



High Density Shelves – SH300/SH500

High density shelving makes bulk items easier to access. Beacon® storage shelves are ideal for any type of inventory, especially fast movers.

SH Series

- SH300 fixed shelves, perfect for storing boxes of UD liquid cups, vials, etc, up to 62 bulk unique items per bay
- SH500 stores an average of 500 unique items
- Configurable in 1, 2 or 3 bays, with drawers, flat shelves, or speed shelves, in any combination



Carousels 120/180

TCGRx Carousels require no floor reinforcement or special wiring.

- Multiple technicians can pick simultaneously using user designated color LED light picking
- 10 independently rotating trays
- Designed for unit of use and unit dose picking
- 2 sizes – 51"Dia. × 83.5"H (120) & 76"Dia. × 91.5"H (180)
- 120 model stores up to 480 SKUs (1200 items)
- 180 model stores up to 600 SKUs (1800 items)

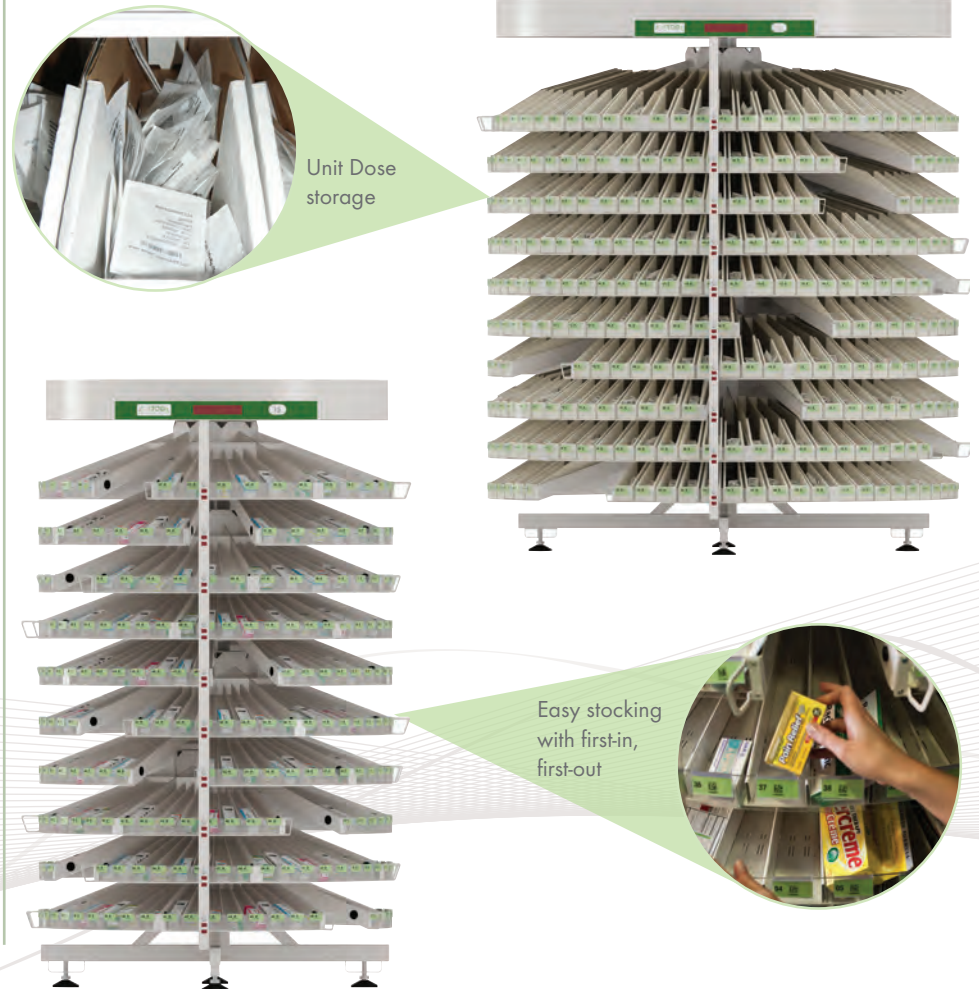

Corner Unit

Corner units are ideal for use in dead corners of the pharmacy and adding additional counter space.

- Storage for servers, printers, paper, pharmacy supplies
- Normally not part of the Beacon inventory management system
- Can bridge together workstations and/or islands



Islands

Islands make great use of open space behind fill counters or will call. Used for compounding, pharmacist check, order staging, or when overhead storage is not needed.

- Storage for servers, printers, paper, pharmacy supplies
- Available in 1, 2 or 3 bay configurations with adjustable flat shelves or pull-out drawers
- Foot rest on bottom for ergonomic work environment
- Normally not part of the Beacon inventory management system



DeliverRx™ Will Call

Give your pharmacy a cleaner look and feel, and a better way to organize your will call. DeliverRx has unlimited configurations that hold bags, bulk and refrigerated items.

- Reduces search time by using LED pick-to-light to find the right prescriptions, every time
- Configurable and expandable, any number of hanging bags and slots for bulk prescriptions or central fill bags
- Utilizes the same Beacon® barcode technology to deliver all the right meds to the right patients, every time
- Includes return-to-stock reporting, with user defined number of days, at a touch-of-a-button



Room for bulk scripts or refrigerated items



Drawer fronts for a clean will-call appearance





Beacon[®] Design Solutions

Long-Term Care – 172 sq. ft.

Medication Storage Capacity: Approximately 2,550 SKUs/2,900 items

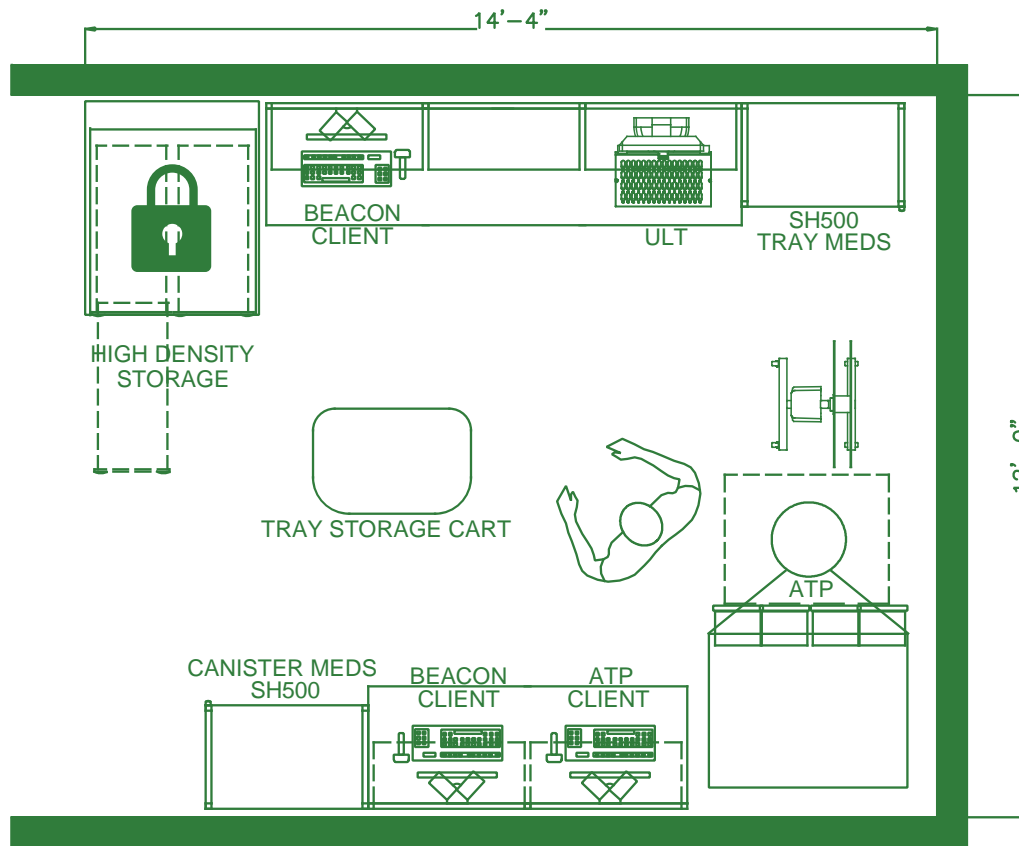

Beacon Fixtures:

- (1) PharmLoc™ – secure med storage
- (1) 3-Bay Workstation – ULT fill station
- (2) 1-Bay SH500 – Canister, tray meds, storage

Automation

- ATP-256
- ULT
- Spooler

Non-Beacon Fixtures

- (1) 2-Bay Workstation – ATP fill station
- (1) ULT Tray Storage Cart

Hospital Inpatient – 352 sq. ft.

Medication Storage Capacity: Approximately 3,600 SKUs/5,500 items

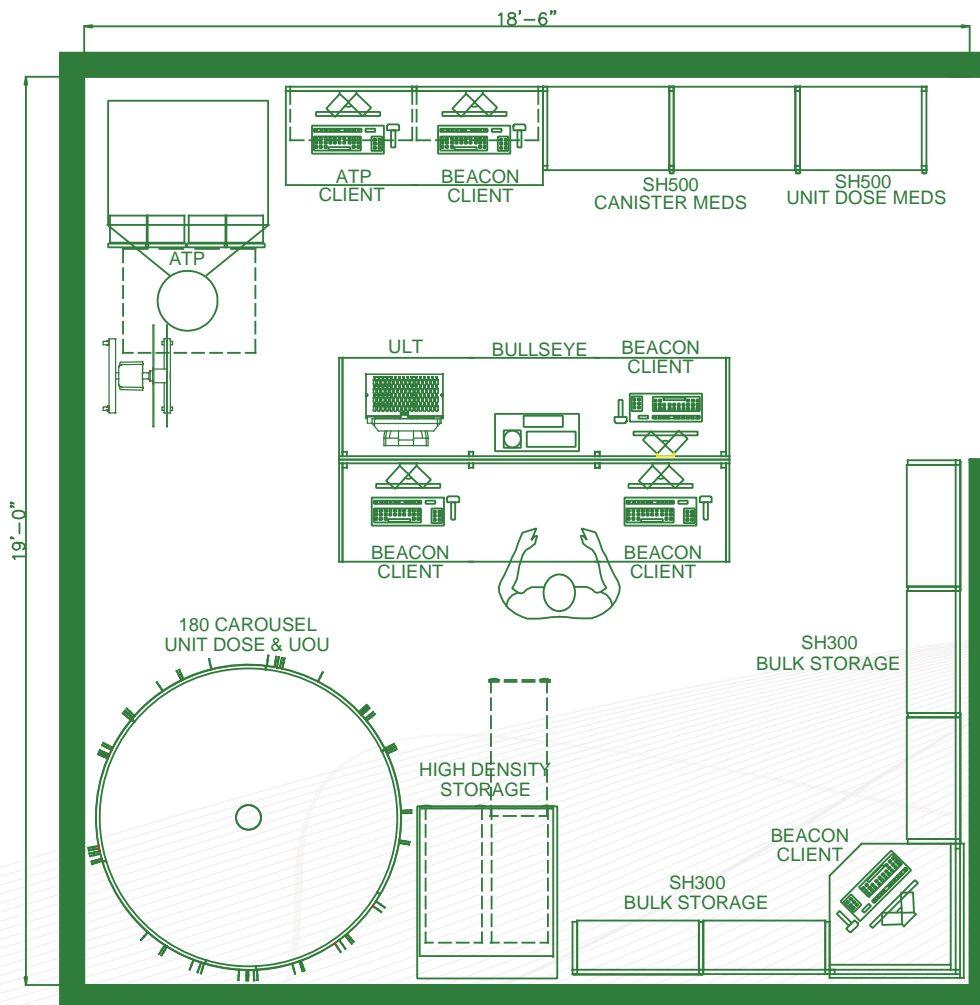

Beacon Fixtures:

- (1) 3-Bay SH500 - Canister and Unit Dose meds
- (1) 3-Bay SH300 - Bulk med packages (UD fluid cups, vials, injectables, etc.)

- (1) 2-Bay SH300 - Bulk med packages
- (1) 2-Bay HD - Bulk storage for slow movers
- (1) Large Carousel - Unit of Use and Unit Dose meds



Non-Beacon Fixtures

- (1) 2-Bay Workstation - ATP fill station
- (2) 3-Bay islands - ULT and cabinet fill stations, miscellaneous pharmacy supply storage
- (1) Corner unit

Automation

- ATP® 2
- ULT
- Spooler
- BullsEye®

Retail small- 297 sq. ft.

Medication Storage Capacity:

Approximately 3,200 SKUs/4,300 items

Will-Call Capacity:

320 Will-Call bags, 24 Bulk slots

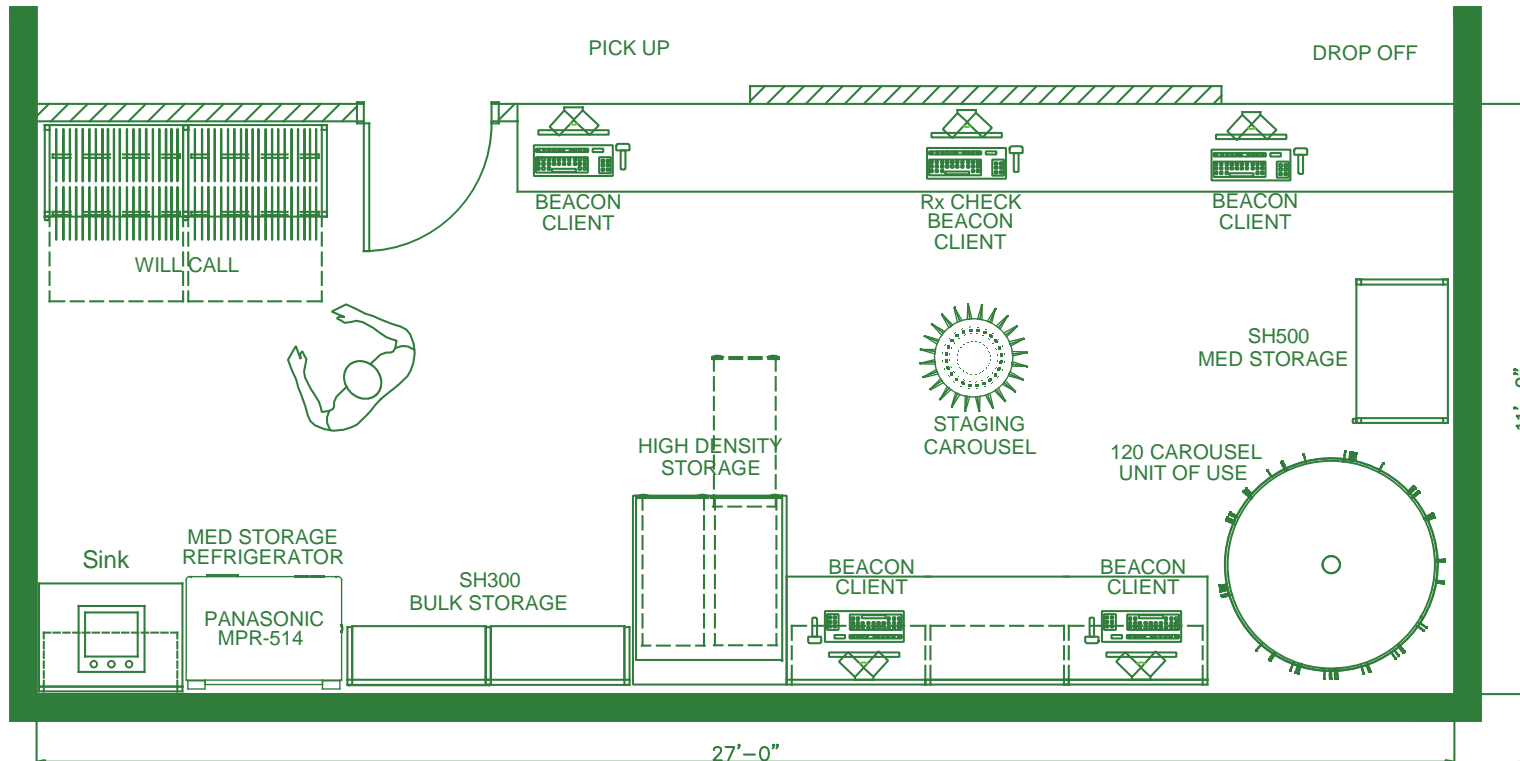

Beacon Fixtures:

- (1) 1-Bay SH500 - Bulk bottles
- (1) Small Carousel - Unit of Use
- (1) 3-Bay Workstation - Fast Movers
- (1) 2-Bay HD - Bulk, slow mover storage

Non-Beacon Fixtures:

- (1) 2-Bay SH300 - Bulk packages
- (1) Panasonic® refrigerator (Beacon) for med storage
- (1) 2-Bay High-Profile Will-Call
- (1) 1-Bay Workstation with sink
- (1) Will-Call staging carousel

Retail large- 572 sq. ft.

Medication Storage Capacity:

Approximately 4,500 SKUs/5,500 items

Will-Call Capacity: 800 Will-Call bags,
75 Bulk slots, Refrigerated Will-Call medications



Beacon Fixtures:

- (1) Small Carousel - Unit of Use
- (2) 2-Bay HD - Slower movers
- (1) 3-Bay Workstation, Rx fill station - Fast movers
- (2) 1-Bay Workstations, Rx Fill Stations - Bulk bottles
- (1) 1-Bay SH500 - Bulk storage
- (2) 3-Bay Low-Profile Will-Call with bag, bulk, refrigerated Will-Call storage
- (1) Panasonic refrigerator for medication storage
- (1) Panasonic refrigerator for Will-Call storage

Automation

- AVF-64/AVF-6 Vial Fillers

Other Fixtures:

- (2) Corner units
- (3) Will-Call staging carousel
- (1) 1-Bay Island - Additional workspace
- (3) 2-Bay islands - Pharmacist check stations
- (1) 1-Bay SH500 - OTC display

